

# Matériel de chaîne

Ball sockets

## String hardware

Socket tongues

## Herrajes de cadenas

Rotulas rectas

TRANSPORT  
TRANSMISSION LINES  
TRANSPORTE



1101-49  
8710

### Ball sockets à tenon

Pour raccordement sur pinces.

- Corps en fonte graphite sphéroïdal à haute limite élastique.
- Galvanisé à chaud.
- Goupille en bronze phosphoreux.

### Socket tongues

To be used with suspension clamps

- Hot dip galvanized cast iron
- Phosphor bronze cotter key

### Rotulas rectas

Para uso con grapas de suspension

- Hierro fundido galvanizado en caliente
- Pasador bronce fosforoso

#### Ball-socket court

#### Short socket

#### Rotula corta

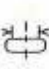
| Référence<br>Cat. Nr.<br>Referencia | <br>mm | P<br>mm | D<br>mm | E<br>mm | Résist.<br>U.T.S.<br>C.R.<br>daN | Poids<br>Weight<br>Peso<br>Kg |
|-------------------------------------|---|---------|---------|---------|----------------------------------|-------------------------------|
| BS16T22                             | 16  | 70      | 20      | 22      | 12000                            | 0,725                         |
| BS16T34                             | 16  | 70      | 20      | 34      | 12000                            | 0,765                         |
| BS16T50                             | 16  | 70      | 20      | 50      | 12000                            | 0,810                         |
| BS20T22                             | 20  | 80      | 20      | 22      | 16500                            | 1,125                         |
| BS20T34                             | 20  | 80      | 20      | 34      | 16500                            | 1,205                         |
| BS20T50                             | 20  | 80      | 20      | 50      | 16500                            | 1,320                         |

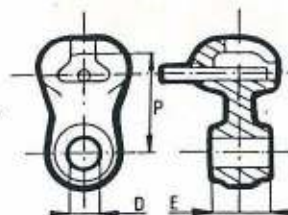

Ball-socket avec carré pour fixation des protections.

#### Socket for arcing horn.

#### Rotula para proteccion.

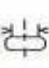
| Référence<br>Cat. Nr.<br>Referencia | <br>mm | P<br>mm | D<br>mm | E<br>mm | Résist.<br>U.T.S.<br>C.R.<br>daN | Poids<br>Weight<br>Peso<br>Kg |
|-------------------------------------|--|---------|---------|---------|----------------------------------|-------------------------------|
| BS16CT22                            | 16   | 120     | 20      | 22      | 12000                            | 0,890                         |
| BS16CT34                            | 16   | 120     | 20      | 34      | 12000                            | 0,930                         |
| BS16CT50                            | 16   | 120     | 20      | 50      | 12000                            | 0,975                         |
| BS20CT22                            | 20   | 130     | 20      | 22      | 16500                            | 1,335                         |
| BS20CT34                            | 20   | 130     | 20      | 34      | 16500                            | 1,425                         |
| BS20CT50                            | 20   | 130     | 20      | 50      | 16500                            | 1,540                         |

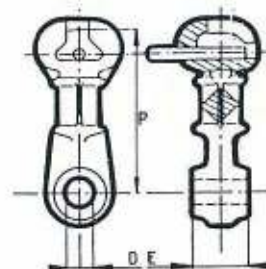

Ball-socket pour isolateur type «Fog» avec carré pour fixation des protections.

#### Socket for arcing horn and «Fog» type insulators.

#### Rotula para proteccion y aisladores tipo «Fog».

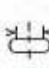
| Référence<br>Cat. Nr.<br>Referencia | <br>mm | P<br>mm | D<br>mm | E<br>mm | Résist.<br>U.T.S.<br>C.R.<br>daN | Poids<br>Weight<br>Peso<br>Kg |
|-------------------------------------|---|---------|---------|---------|----------------------------------|-------------------------------|
| BS16TCT22                           | 16  | 175     | 20      | 22      | 12000                            | 1,100                         |
| BS16TCT34                           | 16  | 175     | 20      | 34      | 12000                            | 1,140                         |
| BS16TCT50                           | 16  | 175     | 20      | 50      | 12000                            | 1,185                         |
| BS20TCT22                           | 20  | 185     | 20      | 22      | 16500                            | 1,550                         |
| BS20TCT34                           | 20  | 185     | 20      | 34      | 16500                            | 1,840                         |
| BS20TCT50                           | 20  | 185     | 20      | 50      | 16500                            | 1,755                         |

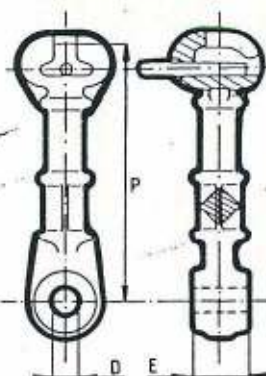

Ball-socket pour travaux sous tension avec carré pour fixation des protections.

#### Long socket for arcing horn and live line work.

#### Rotula alargada para proteccion y trabajo con tension.

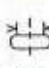
| Référence<br>Cat. Nr.<br>Referencia | <br>mm | P<br>mm | D<br>mm | E<br>mm | Résist.<br>U.T.S.<br>C.R.<br>daN | Poids<br>Weight<br>Peso<br>Kg |
|-------------------------------------|---|---------|---------|---------|----------------------------------|-------------------------------|
| BS16CTT22                           | 16  | 240     | 20      | 22      | 12000                            | 1,305                         |
| BS16CTT34                           | 16  | 240     | 20      | 34      | 12000                            | 1,345                         |
| BS16CTT50                           | 16  | 240     | 20      | 50      | 12000                            | 1,390                         |
| BS20CTT22                           | 20  | 250     | 20      | 22      | 16500                            | 1,800                         |
| BS20CTT34                           | 20  | 250     | 20      | 34      | 16500                            | 1,890                         |
| BS20CTT50                           | 20  | 250     | 20      | 50      | 16500                            | 2,005                         |

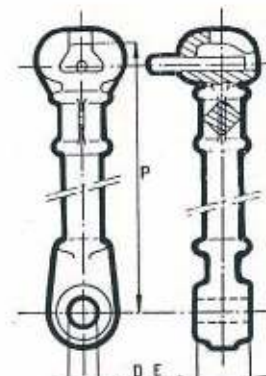

# Matériel de chaîne

Ball sockets

## String hardware

Socket tongues

## Herrajes de cadenas

Rotulas rectas

TRANSPORT  
TRANSMISSION LINES  
TRANSPORTE



1101-50  
R710

### Ball sockets à tenon

- Corps en fonte graphite sphéroïdal à haute limite élastique.
- Galvanisé à chaud.
- Goupille en bronze phosphoreux.

### Socket tongues

- Hot dip galvanized cast iron
- Phosphor bronze cotter key

### Rotulas rectas

- Hierro fundido galvanizado en caliente
- Pasador bronce fosforoso

Ball-socket court

Short socket

Rotula corta

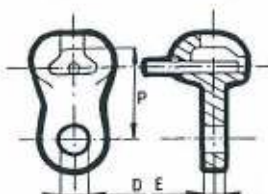

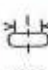
| Référence<br>Cat. Nr.<br>Referencia | <br>mm | P<br>mm  | D<br>mm  | E<br>mm  | Résist.<br>U.T.S.<br>C.R.<br>daN | Poids<br>Weight<br>Peso<br>Kg |
|-------------------------------------|---|----------|----------|----------|----------------------------------|-------------------------------|
| BS 16 T<br>BS 20 T                  | 16<br>20  | 70<br>80 | 20<br>20 | 16<br>16 | 12000<br>16500                   | 0,705<br>1,070                |

Ball-socket avec carré pour fixation des protections.

Socket for arcing horn.

Rotula para proteccion.

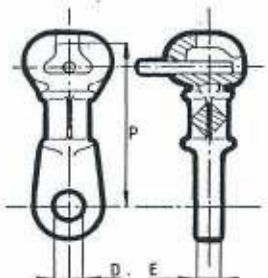

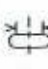
| Référence<br>Cat. Nr.<br>Referencia | <br>mm | P<br>mm    | D<br>mm  | E<br>mm  | Résist.<br>U.T.S.<br>C.R.<br>daN | Poids<br>Weight<br>Peso<br>Kg |
|-------------------------------------|--|------------|----------|----------|----------------------------------|-------------------------------|
| BS 16 CT<br>BS 20 CT                | 16<br>20   | 120<br>130 | 20<br>20 | 16<br>16 | 12000<br>16500                   | 0,870<br>1,290                |

Ball-socket pour isolateur type «Fog» avec carré pour fixation des protections.

Socket for arcing horn and «Fog» type insulators.

Rotula para proteccion y aisladores tipo «Fog».

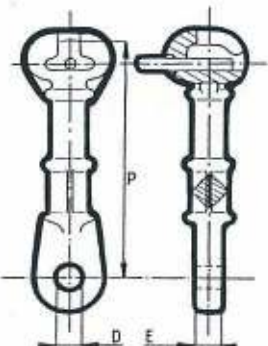

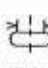
| Référence<br>Cat. Nr.<br>Referencia | <br>mm | P<br>mm    | D<br>mm  | E<br>mm  | Résist.<br>U.T.S.<br>C.R.<br>daN | Poids<br>Weight<br>Peso<br>Kg |
|-------------------------------------|---|------------|----------|----------|----------------------------------|-------------------------------|
| BS 16 TCT<br>BS 20 TCT              | 16<br>20  | 175<br>185 | 20<br>20 | 16<br>16 | 12000<br>16500                   | 1,080<br>1,505                |

Ball-socket pour travaux sous tension avec carré pour fixation des protections.

Long socket for arcing horn and live line work.

Rotula alargada para proteccion y trabajo con tension.

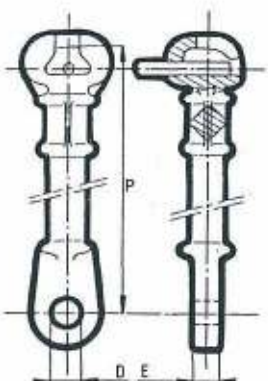

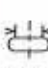
| Référence<br>Cat. Nr.<br>Referencia | <br>mm | P<br>mm    | D<br>mm  | E<br>mm  | Résist.<br>U.T.S.<br>C.R.<br>daN | Poids<br>Weight<br>Peso<br>Kg |
|-------------------------------------|---|------------|----------|----------|----------------------------------|-------------------------------|
| BS 16 CTT<br>BS 20 CTT              | 16<br>20  | 240<br>250 | 20<br>20 | 16<br>16 | 12000<br>16500                   | 1,285<br>1,755                |